

The Walmesley Room

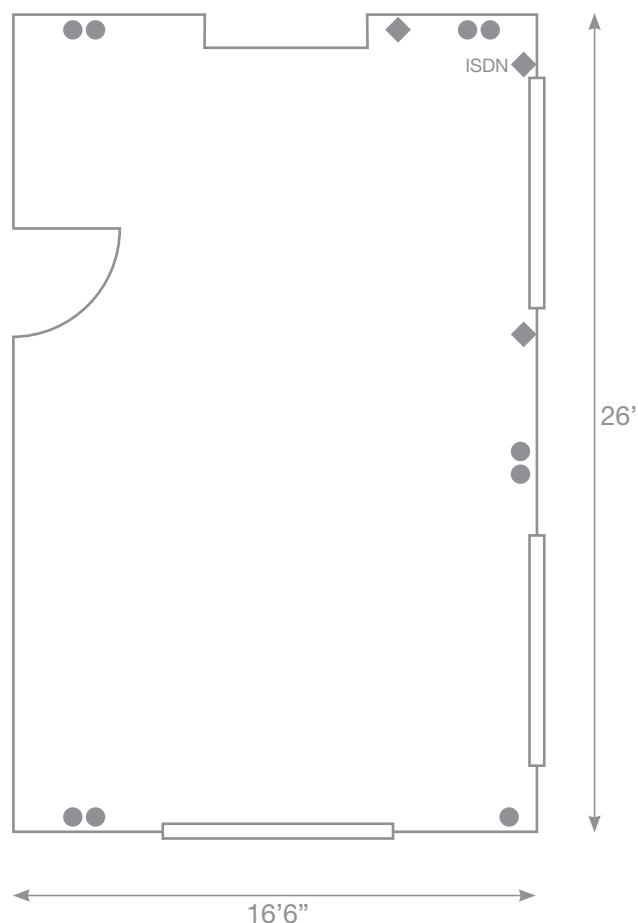

LOCATION: Ground floor in the main house overlooking the courtyard with natural daylight.

DIMENSIONS:

Area (sq feet)	429
Length	26'
Width	16'6"
Height	8'

ROOM LAYOUT:

Theatre style	40
Classroom style	0
U shape	18
Boardroom	18
Private dining	22 (1 table)

◆ = Telephone point

● = Power point

TV = TV aerial

Plan not to scale

The Wallis Room

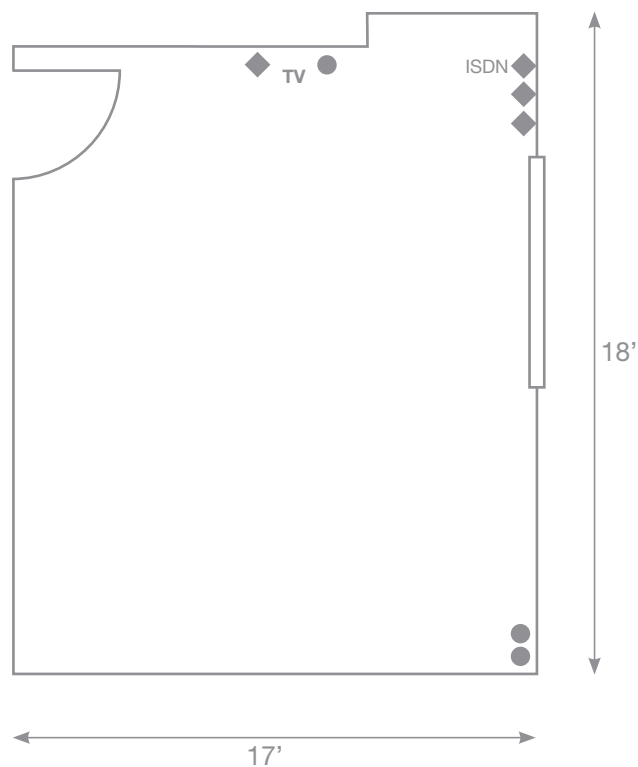

LOCATION: Ground floor in the main house overlooking the courtyard with natural daylight.

DIMENSIONS:

Area (sq feet)	306
Length	18'
Width	17'
Height	8'

ROOM LAYOUT:

Theatre style	16
Classroom style	0
U shape	0
Boardroom	10
Private dining	12

◆ = Telephone point

● = Power point

TV = TV aerial

Plan not to scale

The Music Room

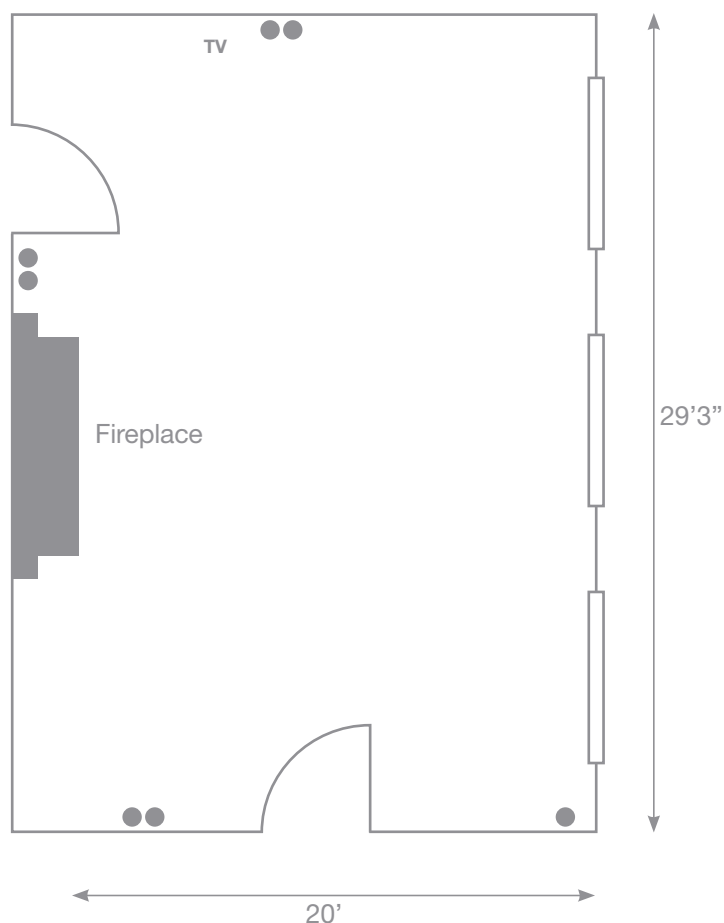

LOCATION: Ground floor in the main house overlooking the main entrance and avenue with natural daylight.

DIMENSIONS:

Area (sq feet)	580
Length	29'
Width	20'
Height	14'

ROOM LAYOUT:

Theatre style	50
Classroom style	24
U shape	24
Boardroom	24
Private dining	30 (3 tables)
	24 (1 table)

◆ = Telephone point

● = Power point

tv = TV aerial

Plan not to scale

The Boardroom

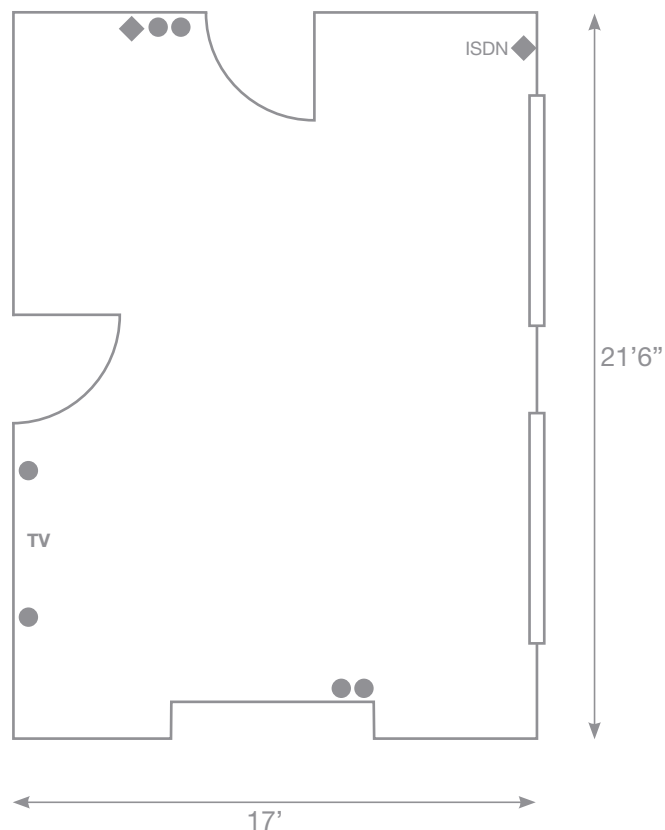

LOCATION: Ground floor in the main house overlooking the courtyard with natural daylight.

DIMENSIONS:

Area (sq feet)	365
Length	21'6"
Width	17'
Height	8'

ROOM LAYOUT:

Theatre style	n/a
Classroom style	0
U shape	0
Boardroom	8
Private dining	8

◆ = Telephone point

● = Power point

TV = TV aerial

Plan not to scale



LUCKNAM PARK

HOTEL & SPA, BATH

